

VL-621

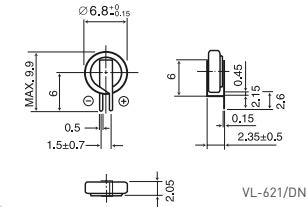

VL-1220

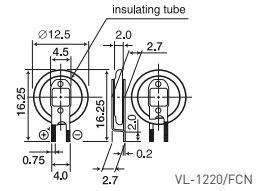

SPECIFICATIONS	
Name	VL-621
Nominal voltage (V)	3
Nominal capacity (mAh)	1.5
Continuous drain (mA)	0.01
Operating temperature (°C)	-20 to +60
Weight (g)	0.3

SPECIFICATIONS	
Name	VL-1220
Nominal voltage (V)	3
Nominal capacity (mAh)	7.0
Continuous drain (mA)	0.02
Operating temperature (°C)	-20 to +60
Weight (g)	0.8

