

PQ1233XT8/T11 (12V 33Ah)

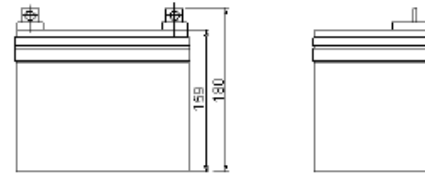

Specifications		PQ1233XT8/T11
Nominal Voltage		12V
Rated Capacity 77°F(25°C) (10HR)		33.0Ah
Dimensions (mm)	Length	195 (7.68)
	Width	130 (5.12)
	Height	155 (6.10)
	Total Height	180 (7.09)
Approx. Weight (kg)		9.6 (21.16)
Terminal		T8/T11

Characteristic		
Capacity 77°F(25°C)	20HR (1.75A)	35.0Ah
	10HR (3.30A)	33.0Ah
	5HR (6.61A)	28.1Ah
	1HR (18.15A)	18.2Ah
	15 min rate (57.75A)	14.4Ah
Internal Resistance	Full Charged Battery	Approx.
	77°F(25°C)	10.5mΩ
Temperature dependence of capacity (20HR)	104°F(40°C)	102%
	77°F(25°C)	100%
	32°F(0°C)	85%
	5°F(-15°C)	65%
Self-Discharge 68°F(20°C) (Capacity after)	3 months	90%
	6 months	80%
	12 months	60%
Max. Discharge Current, 77°F(25°C)		330A(5s)
Floating design life, 77°F(20°C)		10 years
Constant Voltage Charge, 77°F(25°C)	Cycle	14.4~14.7V(-24mV/°C) max. current: 8.25 A
	Float	13.6~13.8V(-18mV/°C)

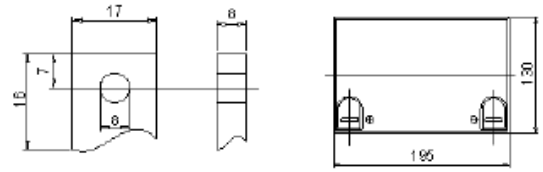
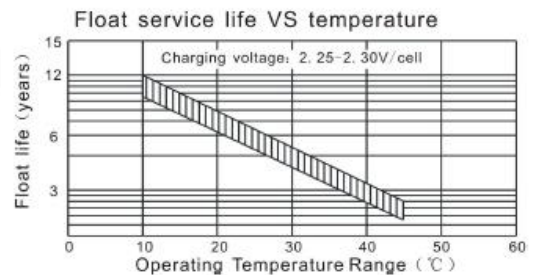
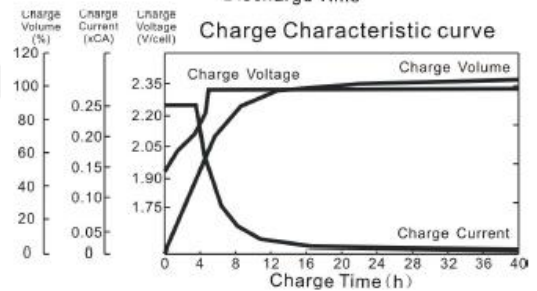
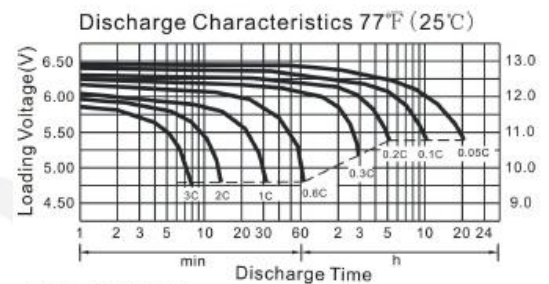

Constant Current Discharge Characteristics (A), 77°F(25°C)											
F.V/TIME	5min	10min	15min	30min	60min	2H	3H	5H	8H	10H	20H
1.60V/cell	112.2	92.6	57.7	33.0	19.1	11.88	8.76	5.92	3.96	3.44	1.80
1.70V/cell	106.6	69.0	55.1	31.6	18.5	11.44	8.56	5.81	3.92	3.40	1.78
1.75V/cell	101.6	64.7	54.2	30.9	18.2	11.22	8.39	5.71	3.84	3.35	1.77
1.80V/cell	95.4	59.8	53.2	30.3	17.9	11.03	8.25	5.61	3.80	3.30	1.75

Constant Wattage Discharge Characteristics (Watt), 77°F(25°C)											
F.V/TIME	5min	10min	15min	30min	60min	2H	3H	5H	8H	10H	20H
1.60V/cell	199.1	131.8	105.8	60.7	35.4	22.20	16.50	11.28	7.60	6.72	3.51
1.70V/cell	191.0	126.4	102.0	58.6	34.5	21.54	16.27	11.12	7.58	6.70	3.51
1.75V/cell	183.8	119.7	101.1	57.9	34.2	21.32	16.09	11.02	7.52	6.65	3.51
1.80V/cell	174.1	111.5	100.2	57.4	33.9	21.13	15.95	10.96	7.46	6.60	3.50