

# MODEL TLH-2450

With insulating bottom disc

## TECHNICAL DATA

(Typical values @+25°C for batteries stored for one year or less)

■ Nominal capacity @ 0.5 mA, to 2V	0.55 Ah
■ Rated voltage	3.6 V
■ Maximum recommended continuous current	5 mA
■ Maximum pulse current capability	10 mA
■ Weight	8.8g (0.310 oz)
■ Volume	2.60 cc
■ Operating temperature range	-55°C to +125°C
■ Maximum duration @ +150°C	3 hours
■ U.L. Component Recognition MH 12193	
Li metal content	approx. 0.2g

## TADIRAN LITHIUM BATTERIES

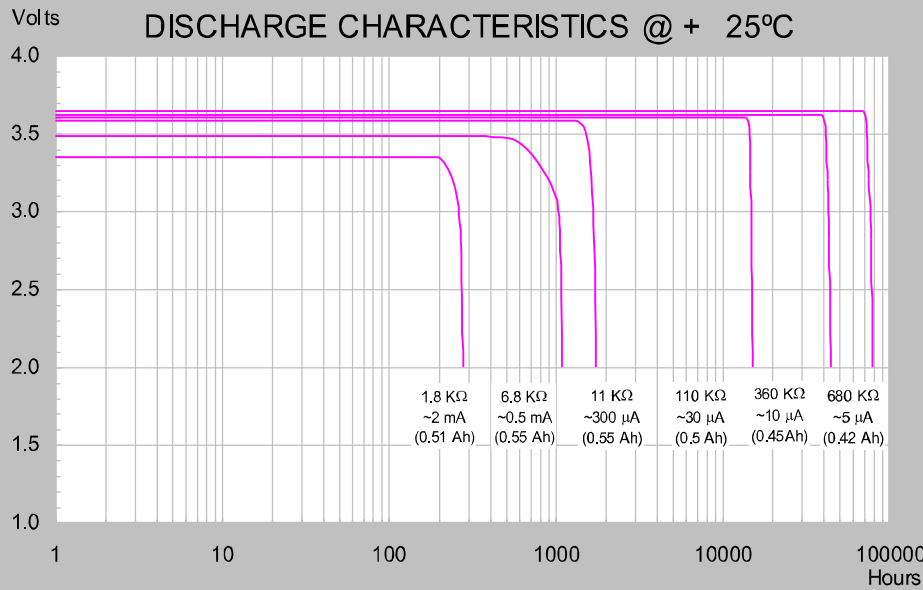
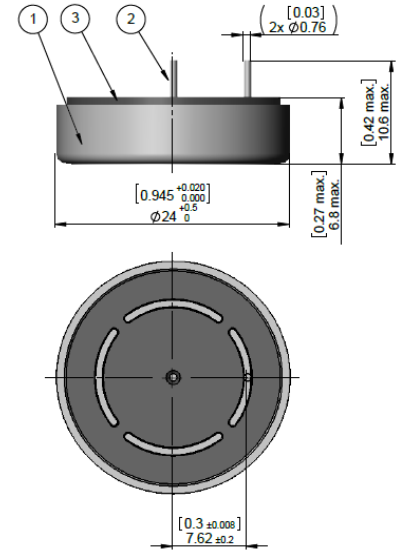

### ADDITIONAL INFORMATION

SUFFIX- /P TIN PLATED NICKEL PINS  
CATALOGUE NO.: 15-2450-41530

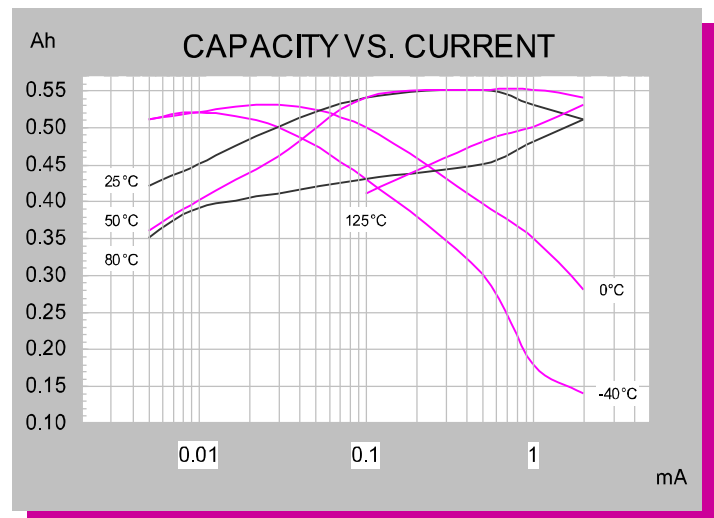
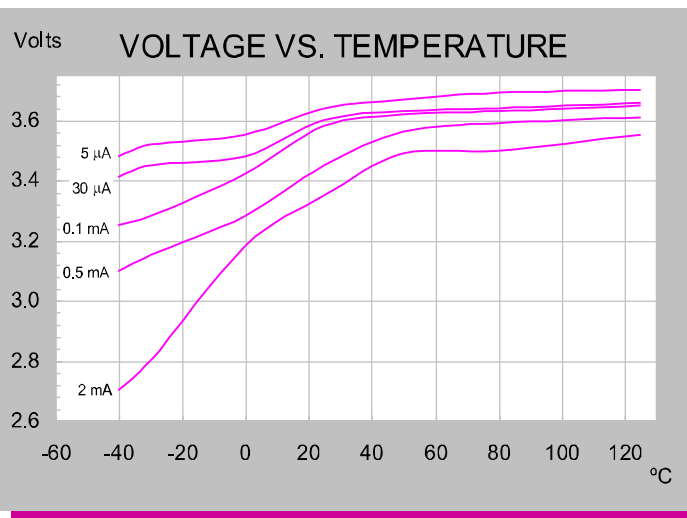

## For Tire Pressure Monitoring Systems

Note: Any presentations in this data sheet concerning performance are for information purpose only and are not construed as warranties either expressed or implied, of future performance.  
ECN 1504054 Rev. E 03/21

# TLH-2450

## CELL FEATURES

- 3.6 V Primary lithium-thionyl chloride (Li-SOCl<sub>2</sub>)
- Fast voltage recovery after long term storage and/or usage
- High energy density
- High and stable operating voltage
- Low self discharge rate
- Wafer construction
- Hermetic glass-to-metal-sealing
- Non-flammable electrolyte

# TADIRAN LITHIUM BATTERIES

## MAIN APPLICATIONS

- TPMS -Tire pressure monitoring systems
- Industrial utilities at high operating temp -up to 125C
- others

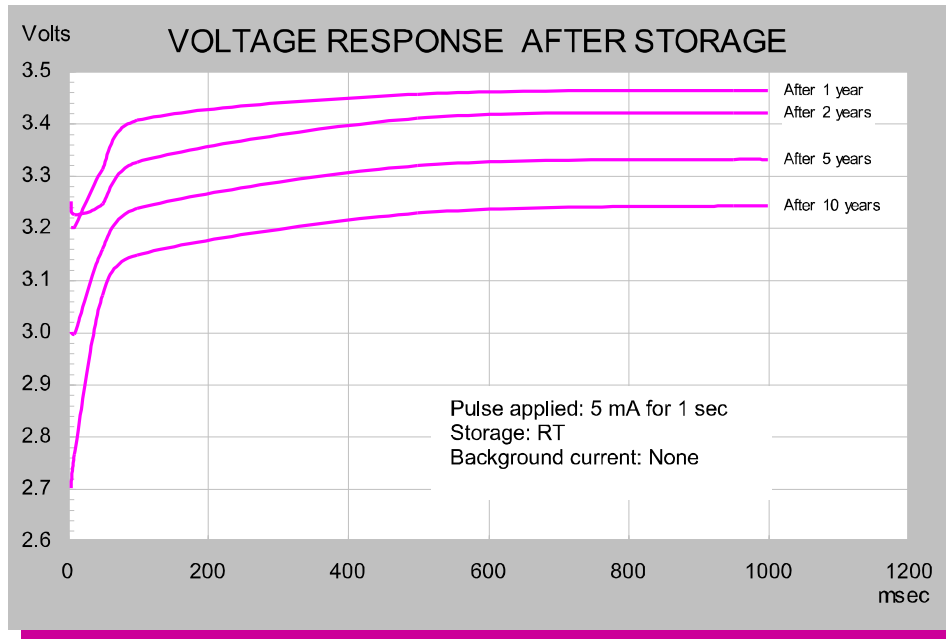

## STORAGE CONDITIONS

- Cells should be stored in a clean & dry (less than 30 % RH) area

For updated information please visit our website [www.tadiranbat.com](http://www.tadiranbat.com)

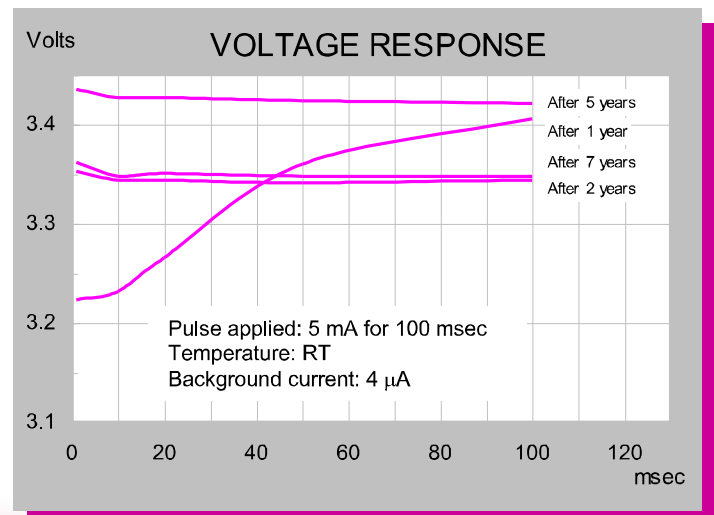
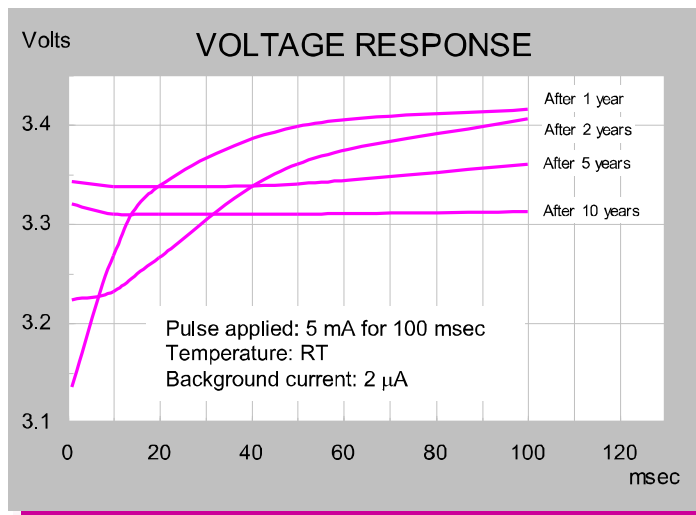

## For Tire Pressure Monitoring Systems